

SPL Series



Standard specifications

Structure

- Drive: Direct shaft coupling type
- Gas seal: V-ring
- Pump body piping: FRP
- Casing: Integrated molded volute type
- Impeller: Closed type (Shaft sleeve integrated)
- Operating temperature range:
 - PP: 0 to 80°C
 - PVDF: 0 to 90°C
- Rotating direction: Clockwise
(When viewed from the motor side)
- Flange: Equivalent to JIS 10K FF
- Motor: 2-pole induction motor with general-purpose flange, for outdoor use
- Paint color: Equivalent to Munsell 2.5B4/8
(Metal parts, such as bed)

Model identification

SPL - 025 1 F 03 P N A

① ② ③④ ⑤ ⑥ ⑦ ⑧

- ① Name
- ② Nozzle diameter
- ③ Frame No.
- ④ O-ring material
F: FPM E: EPDM
- ⑤ Motor output
03: 2.2 kW 05: 3.7 kW
07: 5.5 kW 10: 7.5 kW
15: 11 kW 20: 15 kW
25: 18.5 kW
- ⑥ Body material (casing, impeller, etc.)
P: Made of PP
M: Made of PVDF
- ⑦ Installation condition
T: Outside of tank N: Inside of tank (PVC)*
R: Inside of tank (Other than PVC)
* Indicates materials of suction strainer, discharge pipe and bed plate.
- ⑧ Material of bolts inside tank
A: PP P: PVDF
(Blank: SUS)

50 Hz model capacity chart

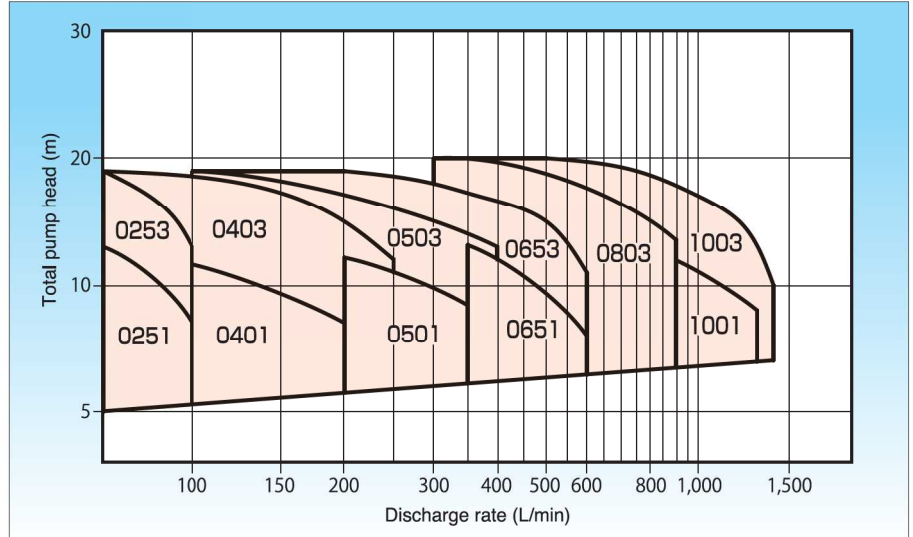

50 Hz model specifications table

Model	Nozzle diameter (mm)	Discharge rate (L/min)	Total pump head (m)	Motor output (kW)
SPL-0251	25	60	10	2.2
SPL-0253		50	14	2.2
SPL-0401	40	150	9	2.2
SPL-0403		200	15	3.7
SPL-0501	50	290	10	3.7
SPL-0503		300	15	3.7
SPL-0651	65	400	12	3.7
SPL-0653		500	15	5.5
SPL-0803	80	800	15	7.5
SPL-1001	100	1,000	10	7.5
SPL-1003		1,200	15	11

Motor output is given for liquids with a specific gravity of 1.0 at the target point.

60 Hz model capacity chart

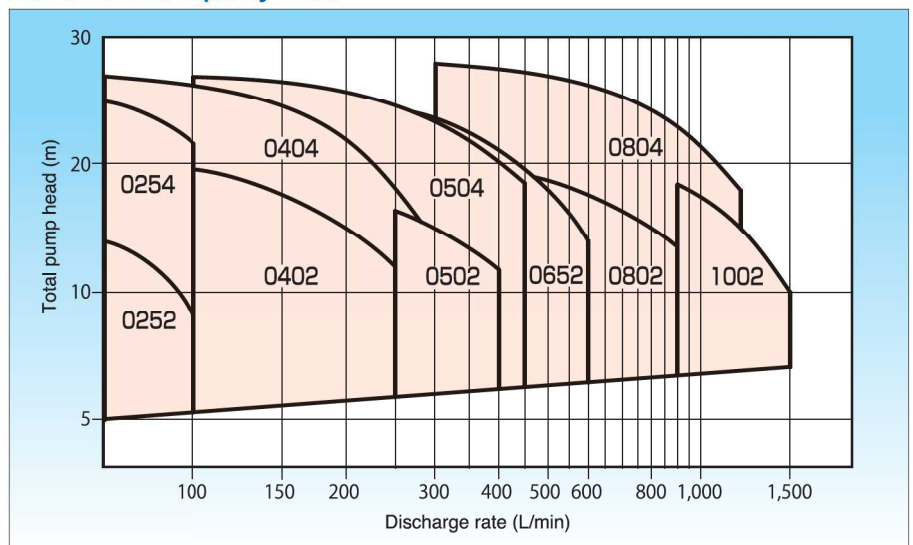

60 Hz model specifications table

Model	Nozzle diameter (mm)	Discharge rate (L/min)	Total pump head (m)	Motor output (kW)
SPL-0252	25	50	12	2.2
SPL-0254		70	23	3.7
SPL-0402	40	200	15	3.7
SPL-0404		200	22	3.7
SPL-0502	50	300	15	5.5
SPL-0504		350	22	5.5
SPL-0652	65	500	18	5.5
SPL-0802	80	800	15	7.5
SPL-0804		800	24	11
SPL-1002	100	1,200	15	11

Motor output is given for liquids with a specific gravity of 1.0 at the target point.

SPL Series

Dimensional drawing

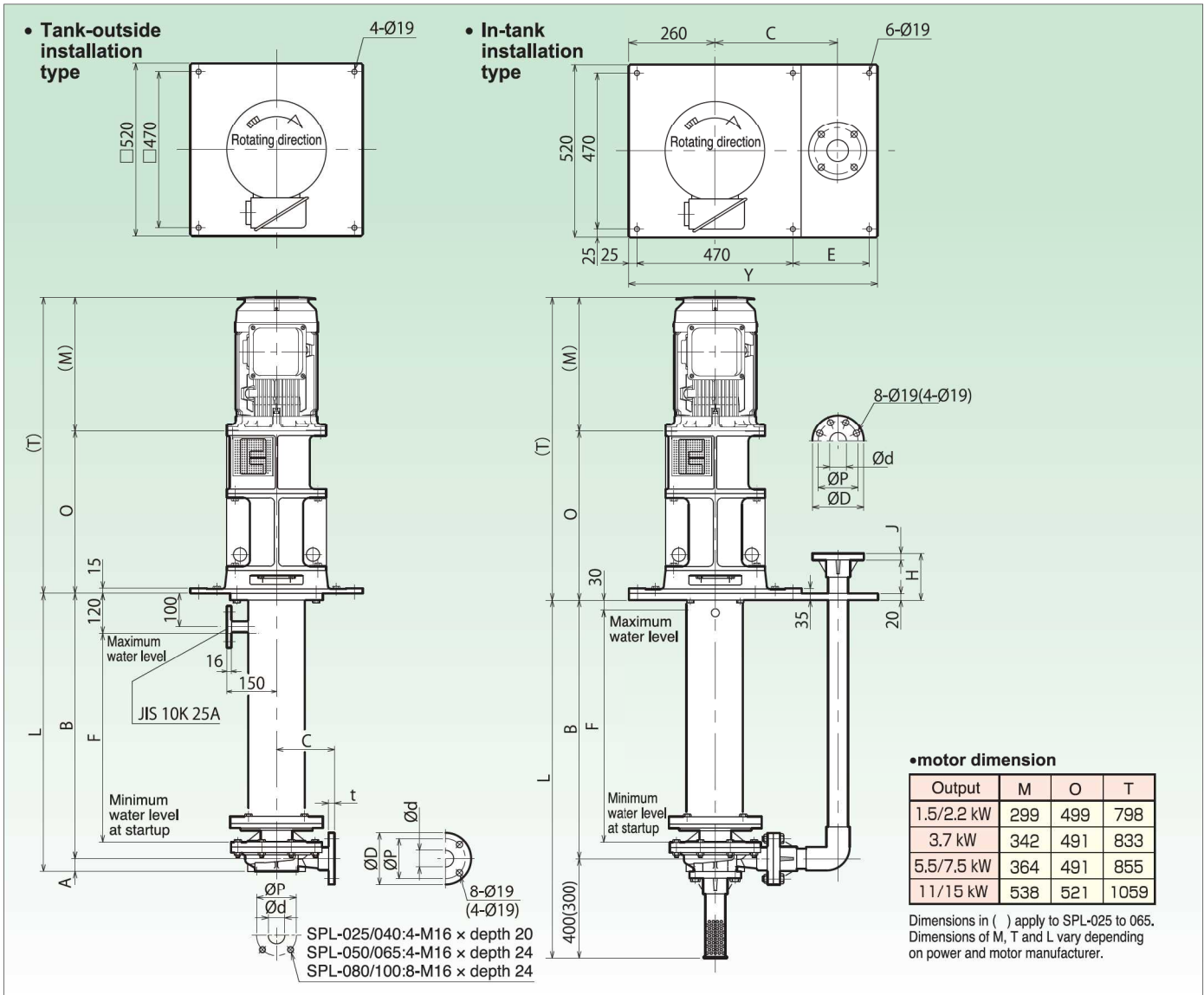

Dimensions table for tank-outside installation type

600 type	A	B	F	L	C	φd	φP	φD	t
SPL-025	25	600	430	625	160	25	90	125	16
SPL-040	25	600	430	625	160	40	105	140	16
SPL-050	38	600	430	638	175	50	120	155	18
SPL-065	38	600	430	638	175	65	140	175	18
SPL-080	50	600	430	650	240	80	150	185	20
SPL-100	50	600	430	650	240	100	175	210	20

Dimensions table for in-tank installation type

600 type	B	F	L	C	E	Y	H	φd	φP	φD	J
SPL-025	580	500	880	370	180	700	120	25	90	125	15
SPL-040	580	500	880	370	180	700	120	40	105	140	16
SPL-050	580	500	880	370	230	750	120	50	120	155	20
SPL-065	580	500	880	370	230	750	120	65	140	175	22
SPL-080	580	500	980	400	280	800	140	80	150	185	22
SPL-100	580	500	980	400	280	800	140	100	175	210	22

800 type	A	B	F	L	C	φd	φP	φD	t
SPL-025	25	800	630	825	160	25	90	125	16
SPL-040	25	800	630	825	160	40	105	140	16
SPL-050	38	800	630	838	175	50	120	155	18
SPL-065	38	800	630	838	175	65	140	175	18
SPL-080	50	800	630	850	240	80	150	185	20
SPL-100	50	800	630	850	240	100	175	210	20

800 type	B	F	L	C	E	Y	H	φd	φP	φD	J
SPL-025	780	700	1080	370	180	700	120	25	90	125	15
SPL-040	780	700	1080	370	180	700	120	40	105	140	16
SPL-050	780	700	1080	370	230	750	120	50	120	155	20
SPL-065	780	700	1080	370	230	750	120	65	140	175	22
SPL-080	780	700	1180	400	280	800	140	80	150	185	22
SPL-100	780	700	1180	400	280	800	140	100	175	210	22

1000 type	A	B	F	L	C	φd	φP	φD	t
SPL-025	25	1000	830	1025	160	25	90	125	16
SPL-040	25	1000	830	1025	160	40	105	140	16
SPL-050	38	1000	830	1038	175	50	120	155	18
SPL-065	38	1000	830	1038	175	65	140	175	18
SPL-080	50	1000	830	1050	240	80	150	185	20
SPL-100	50	1000	830	1050	240	100	175	210	20

1000 type	B	F	L	C	E	Y	H	φd	φP	φD	J
SPL-025	980	900	1280	370	180	700	120	25	90	125	15
SPL-040	980	900	1280	370	180	700	120	40	105	140	16
SPL-050	980	900	1280	370	230	750	120	50	120	155	20
SPL-065	980	900	1280	370	230	750	120	65	140	175	22
SPL-080	980	900	1380	400	280	800	140	80	150	185	22
SPL-100	980	900	1380	400	280	800	140	100	175	210	22

Cross-section structural drawing

Tank-outside installation type

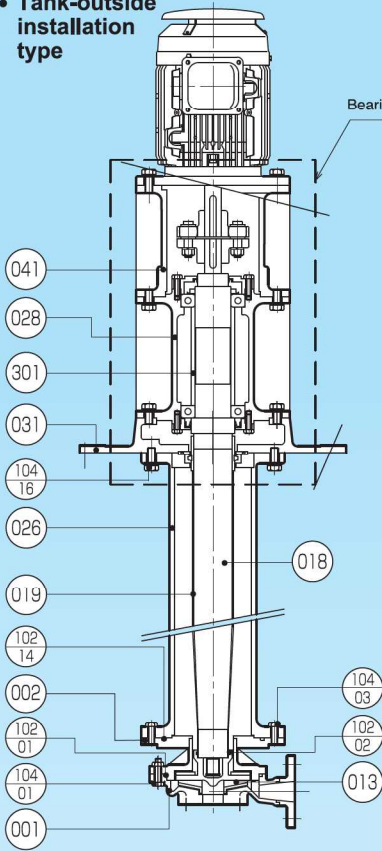

In-tank installation type

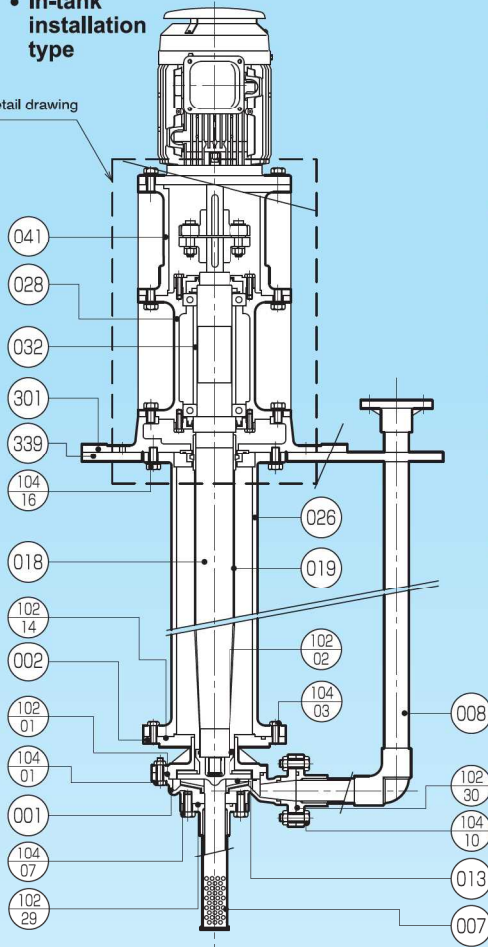

Bearing detail drawing

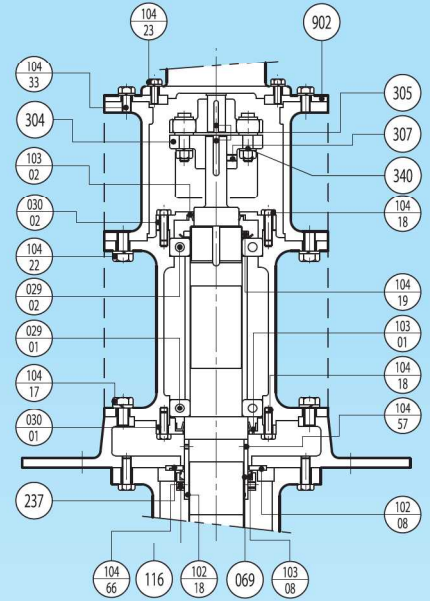

Part No.	Part name	Material	Q'ty
001	Casing	PVDF/PP	1
002	Casing cover	PVDF/PP	1
007	Suction strainer	PVC/HTPVC	1
008	Discharge pipe	PVC/HTPVC	1
013	Impeller	PVDF/PP	1
018	Main shaft	S45C	1
019	Shaft sleeve	FEP	1
026	Pump body piping	FRP	1
028	Bracket	FC200	1
029-01	Bearing (P side)	SUJ2	1
029-02	Bearing (M side)	SUJ2	1
030-01	Bearing cover (P side)	SS400	1
030-02	Bearing cover (M side)	SS400	1
032	Distance piece	SS400	1
041	Motor base	FC200	1
069	Gas seal support	HTPVC	1
102-01	O-ring (Casing)	FPM/EPDM	1
102-02	O-ring (Impeller)	FPM/EPDM	1
102-08	O-ring (Gas seal plate)	EPDM	1
102-14	O-ring (Casing cover)	FPM/EPDM	1
102-18	O-ring (Gas seal support)	EPDM	1
102-29	O-ring (Suction pipe)	FPM/EPDM	1
102-30	O-ring (Discharge pipe)	FPM/EPDM	1
103-01	Oil seal (P side)	FPM	1

Part No.	Part name	Material	Q'ty
103-02	Oil seal (M side)	FPM	1
103-08	V-ring (Gas seal)	FPM	1
104-01	Casing bolt/nut	PVDF/PP	1 set
104-03	Casing cover bolt	PVDF/PP	1 set
104-07	Suction strainer bolt	PVC/HTPVC	1 set
104-10	Discharge pipe bolt/nut	PVDF/PP	1 set
104-16	Pump body piping bolt	PPS	1 set
104-17	Bracket bolt	SUS304	1 set
104-18	Bearing cover bolt	SUS304	1 set
104-19	Rolling bearing nut/washer	SS400	1 set
104-22	Motor base bolt	SUS304	1 set
104-23	Motor bolt	SUS304	1 set
104-33	Motor liner bolt	SUS304	1 set
104-57	Gas seal support bolt	SUS304	1 set
104-66	Gas seal stopper bolt	PVDF	1 set
116	Seal stopper	HTPVC	1
237	Gas seal plate	C-PTFE	1
301	Bed	FC200	1
304	Coupling	FC200	1 set
305	Coupling key	SUS304	1 set
307	Coupling set screw	SCM	1 set
339	Bed plate	PVC	1
340	Coupling pin/rubber	SS400 · NBR	1 set
902	Motor liner	SS400	1

* ● 007: Exchangeable with suction short pipe.

● 104-01/104-03: For tank outside installation, SUS304 is used.