

# MSX-150 Series (Suction 150A×Discharge 125A)



## Pump Specifications

- Operating Temperature 0~90°C
- Rotation Direction Clockwise (viewed from the motor)
- Flange JIS 10K RF (Please consult us about ANSI/DIN standard.)
- Finish Paint Munsell 2.5B4/8(pump body)
- Motor IEC flanged induction motor
- Accessories Base & Foundation bolts (M16×200L×63b)

### 50Hz Performance Curve & Technical Data

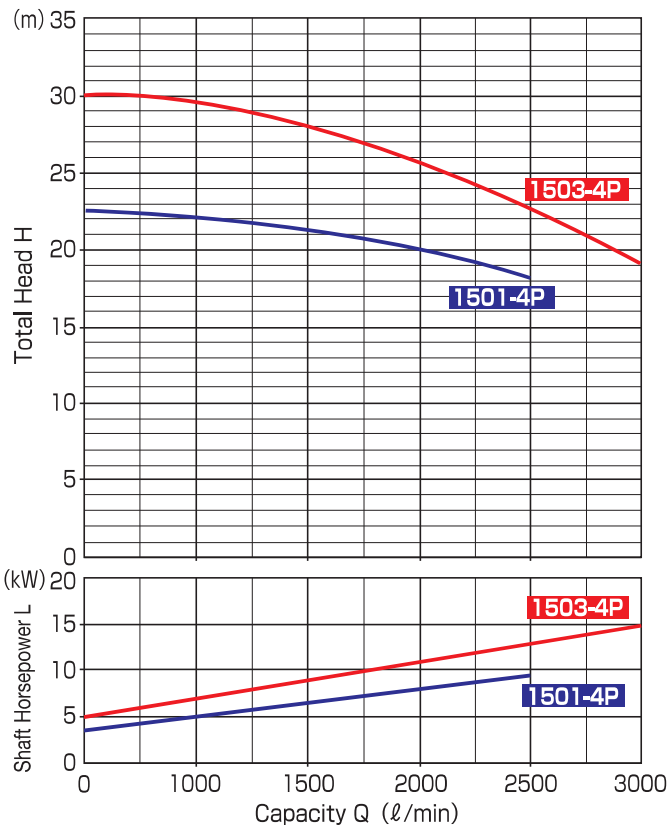

Model	Capacity (ℓ/min)	Total Head (m)	NPSH Re (m)	Motor Output (kW)
MSX-1501-4P	2000	20	2.5	11~30
MSX-1503-4P		22		

Note: NPSH Re value shown in the table is that obtained from the maximum suction pipe diameter.

### 60Hz Performance Curve & Technical Data

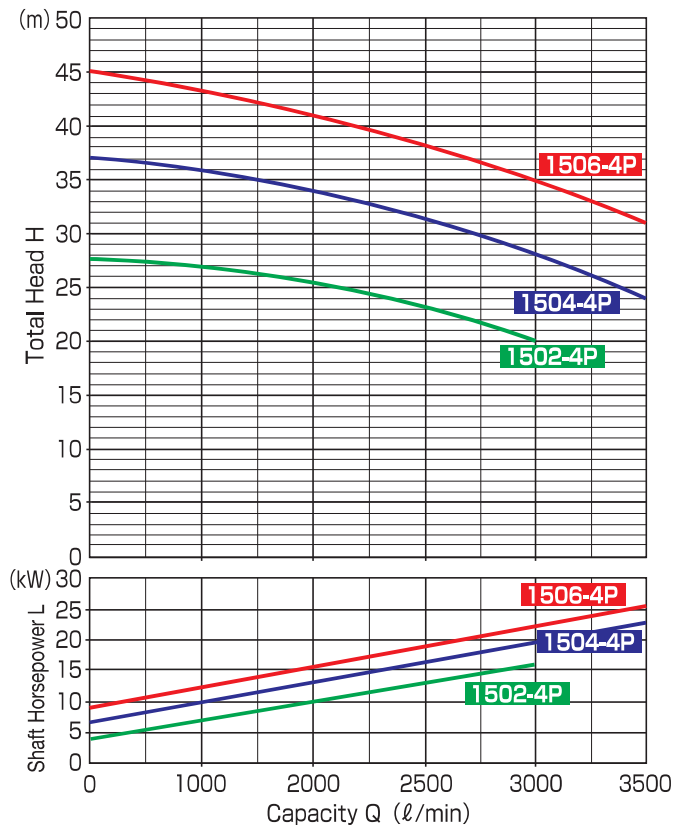

Model	Capacity (ℓ/min)	Total Head (m)	NPSH Re (m)	Motor Output (kW)
MSX-1502-4P	2500	20	3.8	11~30
MSX-1504-4P		30		
MSX-1506-4P	3000	33	4.4	

Note: NPSH Re values shown in the table are those obtained from the maximum suction pipe diameter.

## Pump Identification

**MSX-150 1 P 15 F A L**  
 ① ② ③ ④ ⑤ ⑥ ⑦ ⑧

- ① Model
- ② Suction Pipe Size
- ③ Model Number Please refer to Performance Curve
- ④ Gasket Material P : PTFE (Jacketed) Z : Other
- ⑤ Motor Output 15 : 11kW 20 : 15kW 25 : 18.5kW  
30 : 22kW 40 : 30kW
- ⑥ Pump Body Material

Type	Casing	Impeller	Inner Magnet	Rear Casing
F	ETFE	PVDF	PFA	PFA+PEEK
S	ETFE	PVDF	PFA	SiC
Z	Other Combinations or Special Option			

- ⑦ Parts Material Combination

Type	Shaft	Front Thrust Ring	Mouth Ring	Bearing
A(Standard)	SiC		C-PTFE	
B	SiC			
G	SiC		G-PTFE	
Z	Other Combinations or Special Option			

- ⑧ Construction Identification

"L" is shown for long couplings only.

MSX Series

Dimensions

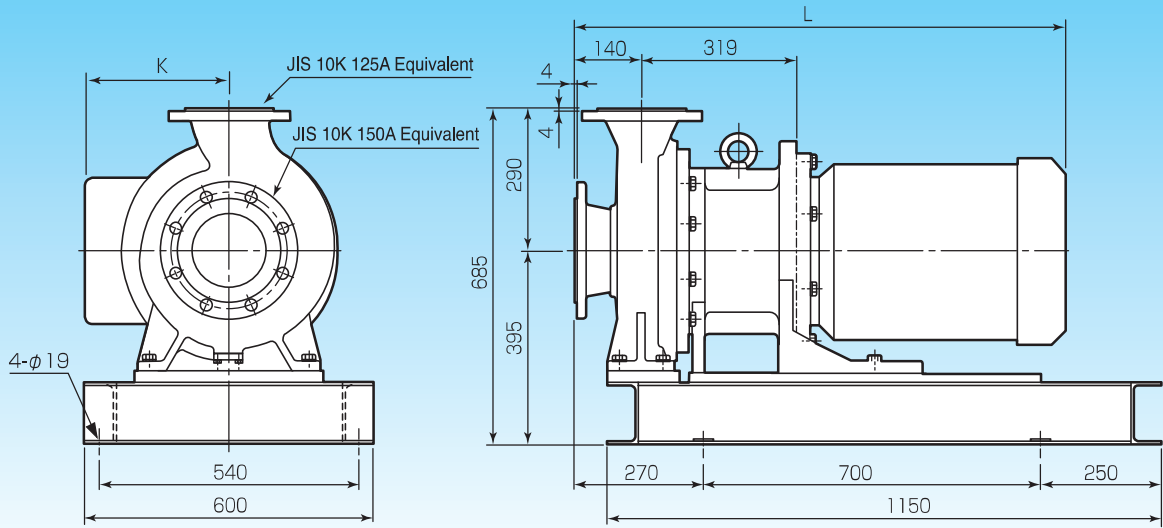

Motor Output (kW)	K	L	Weight (kg)
11~30	(350)	(1020)	(350)

Note: ① The weight of pump does not include the motor weight.  
 ② The dimensions shown above are applicable when a totally-enclosed fan-cooled motor is used.  
 When using special motors (such as explosion-proof motors), please contact us.  
 ③ The figures in parentheses are reference values.

Construction Diagram

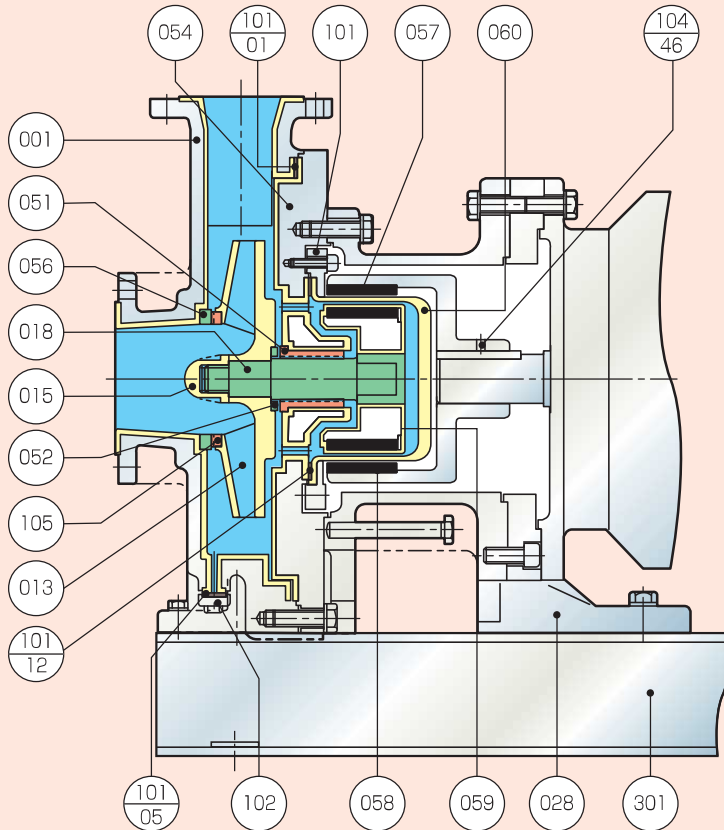

No.	Part Name	Materials
001	Casing	FCD450+ETFE
013	Impeller	PVDF
015	Impeller Nut	C-PTFE
018	Shaft	SiC
028	Bracket	FC200
051	Bearing	C-PTFE / SiC / G-PTFE
052	Rear Thrust Ring	SiC
054	Bearing Plate	FCD450+PFA
056	Front Thrust Ring	SiC
057	Outer Magnet	Rare Earth
058	Inner Magnet	Rare Earth
059	Magnet Lining	PFA
060	Rear Casing	PFA (Wetted Parts) / SiC
101	Rear Casing Ring	SUS304
101-01	Casing Gasket	PTFE
101-05	Drain Gasket	PTFE(Jacketed)
101-12	Rear Casing Gasket	PTFE(Jacketed)
102	Drain Flange	FC200
104-46	Outer Magnet Set Screw	SNCM
105	Mouth Ring	C-PTFE / SiC / G-PTFE
301	Base	SS400

Note: Inner Magnet (058) and Magnet Lining (059) are integrated.