

# MES-080 Series (Suction 80A × Discharge 80A)



## Pump Specifications

- Operating Temperature 0~80℃
- Rotation Direction Clockwise (viewed from the motor)
- Flange JIS 10K FF (Please consult us about ANSI/DIN standard.)
- Finish Paint Munsell 2.5B4/8(pump body)
- Motor TEXEL flanged induction motor / IEC flanged induction motor
- Accessories Base & Foundation bolts (M12×160L×50b)

### 50Hz Performance Curve & Technical Data

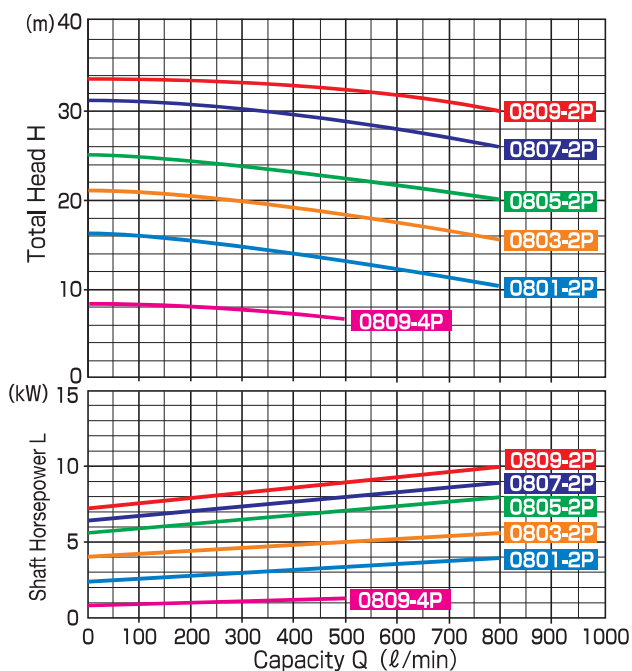

Model	Capacity (ℓ/min)	Total Head (m)	NPSH Re (m)	Motor Output (kW)
MES-0801-2P	800	10	5.0	1.5~18.5
MES-0803-2P		15		
MES-0805-2P		20		
MES-0807-2P		25		
MES-0809-2P		30		
MES-0809-4P	400	7.5	5.0	1.5~3.7

Note: NPSH Re values shown in the table are those obtained from the maximum suction pipe diameter.

### 60Hz Performance Curve & Technical Data

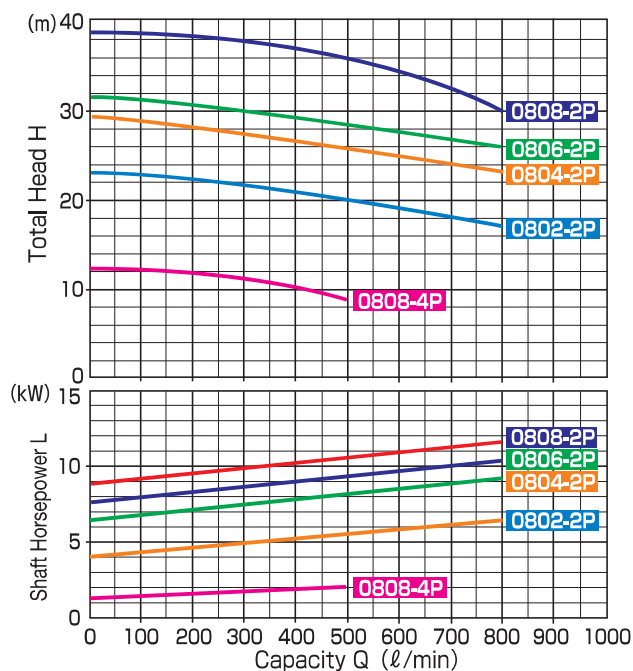

Model	Capacity (ℓ/min)	Total Head (m)	NPSH Re (m)	Motor Output (kW)
MES-0802-2P	800	17	6.5	1.5~18.5
MES-0804-2P		20		
MES-0806-2P		25		
MES-0808-2P		30		
MES-0808-4P	400	10	6.0	1.5~3.7

Note: NPSH Re values shown in the table are those obtained from the maximum suction pipe diameter.

## Pump Identification

MES - 080 1 E 02 A C A 4  
 ① ② ③④ ⑤ ⑥ ⑦⑧ ⑨

- ① Model ② Suction Pipe Size
- ③ Model Number Please refer to Performance Curve
- ④ Gasket Material E: EPDM (O-ring) and PTFE (Jacketed)  
F: EPM (O-ring) and PTFE (Jacketed) Z: Other
- ⑤ Motor Output  
02 : 1.5kW 03 : 2.2kW 05 : 3.7kW 07 : 5.5kW  
10 : 7.5kW 15 : 11kW 20 : 15kW 25 : 18.5kW
- ⑥ Pump Body Material

Type	Casing/Tank	Shaft Support/Drain	Impeller+Inner Magnet	Rear Casing
A	G-Epoxy	PP	PFA	PFA + Eng.Plastic
C	C-Epoxy			
P	G-Epoxy	PVDF		
Z	Other Combinations or Special Option			

### ⑦ Motor Type

C: TEFC/outdoor TEXEL motor D: Explosion-proof increased safety (eG3) TEXEL motor  
T: IEC standard explosion-proof (d2G4) motor

### ⑧ Material Combination

Type	Shaft	Front Thrust Ring	Rear Thrust Ring	Mouth Ring	Bearing
A(Standard)	Alumina-ceramic			C-PTFE	
B	SiC				
C	SiC			Carbon	
E	SiC			C-PTFE	
F	Alumina-ceramic			Carbon	
G	Alumina-ceramic			G-PTFE	
Z	Other Combinations or Special Option				

⑨ Number of Poles "4" is shown only when a 4-pole motor is installed.

Dimensions

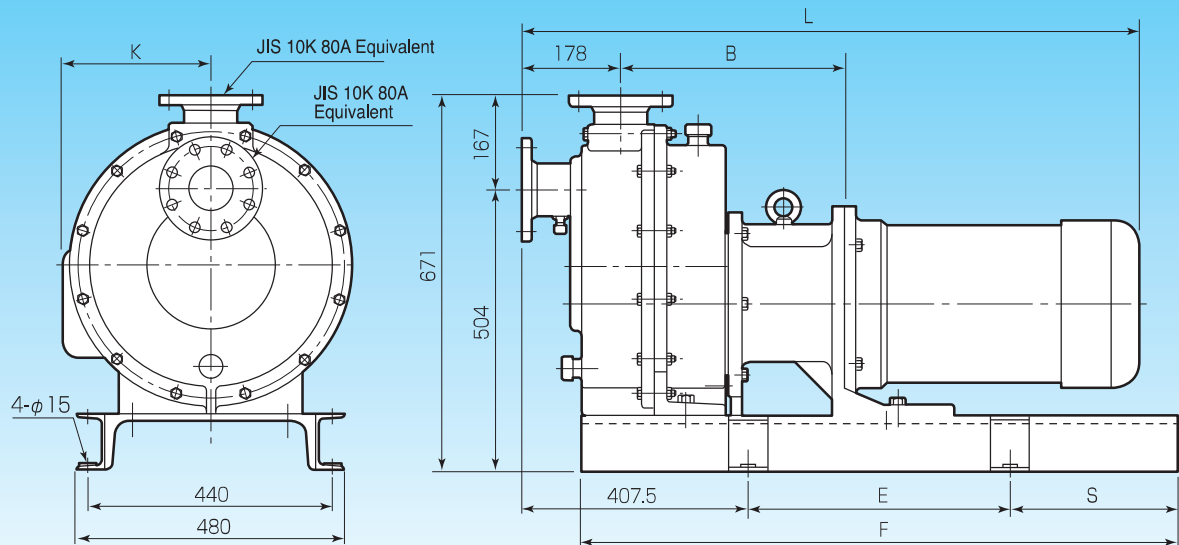

Motor Output (kW)	B	K	L	E	F	S	Weight (kg)
1.5 / 2.2	343	—	(810)	300	800	200	(135)
3.7	353	—	(845)				(137)
5.5 / 7.5	373	—	(952)	470	1070	300	(158)
11 / 15 / 18.5	403	(265)	(1110)				(166)

Note: ① The weight of pump does not include the motor weight.  
 ② The dimensions shown above are applicable when a totally-enclosed fan-cooled 2-pole motor is used. When using special motors (such as explosion-proof motors), please contact us.  
 ③ The figures in parentheses are reference values.

Construction Diagram

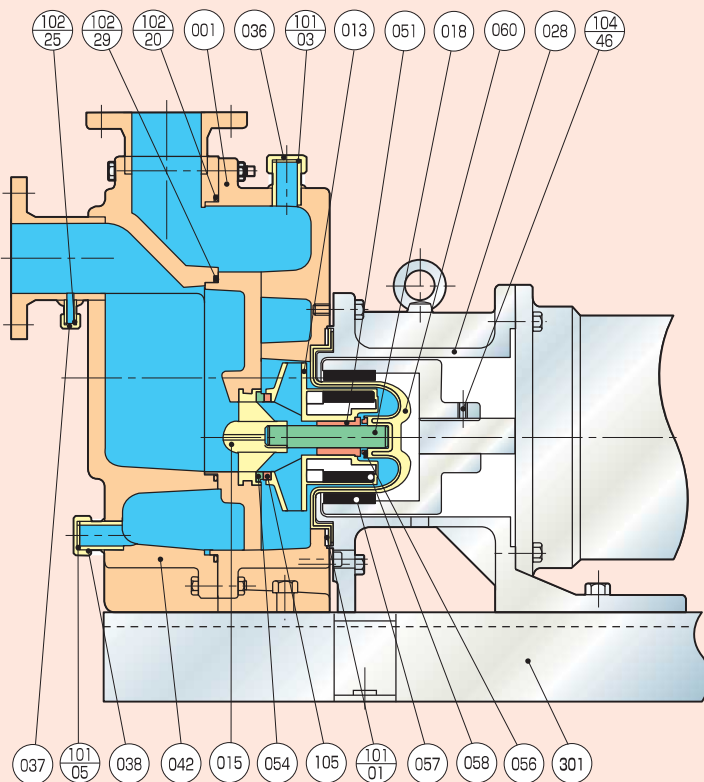

No.	Part Name	Materials
001	Casing	G-EA
		C-EA
013	Impeller + Magnet Lining	PFA
015	Shaft Support	PP / PVDF
018	Shaft	Alumina-ceramic / SiC
028	Bracket	FC200
036	Priming Plug	PP / PVDF
037	Air Vent Plug	PP / PVDF
038	Drain Plug	PP / PVDF
042	Tank	G-EA
		C-EA
051	Bearing	C-PTFE / SiC / Carbon / G-PTFE
054	Front Thrust Ring	Alumina-ceramic / SiC
056	Rear Thrust Ring	Alumina-ceramic / SiC
057	Outer Magnet	Rare Earth
058	Inner Magnet	Rare Earth
060	Rear Casing	PFA (Wetted Parts)
101-01	Casing Gasket	PTFE
101-03	Priming Plug Gasket	FPM / EPDM
101-05	Drain Plug Gasket	FPM / EPDM
102-20	O-ring(Tank)	FPM / EPDM
102-25	O-ring(Air Vent Plug)	FPM / EPDM
102-29	O-ring(Suction)	FPM / EPDM
104-46	Outer Magnet Set Screw	SNCM
105	Mouth Ring	C-PTFE / SiC / Carbon / G-PTFE
301	Base	SS400

Note: Inner Magnet (058) and Impeller (013) are integrated.