

# MEH-040 Series (Suction 40A × Discharge 20A)



## Pump Specifications

- Operating Temperature 0~90℃
- Rotation Direction Clockwise (viewed from the motor)
- Flange JIS 10K RF (Please consult us about ANSI/DIN standard.)
- Finish Paint Munsell 2,5B4/8(pump body)
- Motor TEXEL flanged induction motor / IEC flanged induction motor
- Accessories Foundation bolts (M12×160L×50b)

### 50Hz Performance Curve & Technical Data

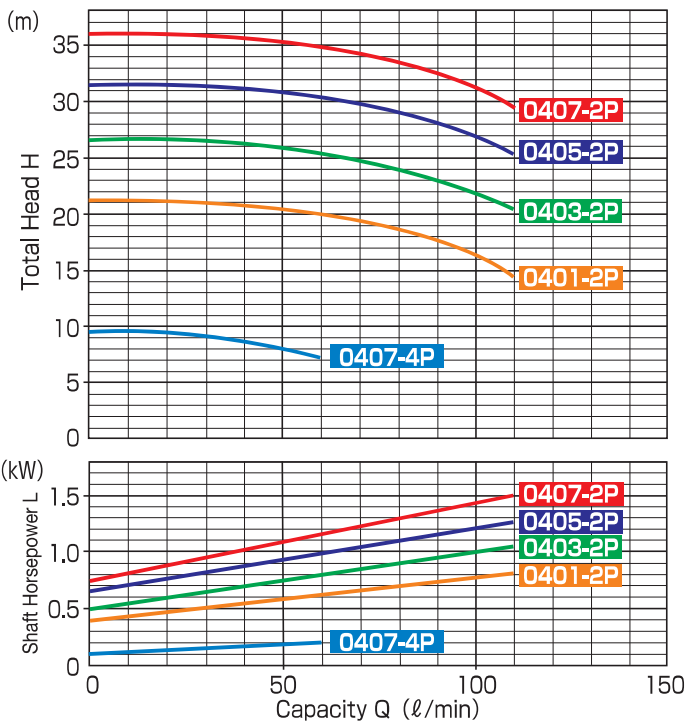

Model	Capacity (ℓ/min)	Total Head (m)	NPSH Re (m)	Motor Output (kW)
MEH-0401-2P	50	20	2.2	0.75~3.7
MEH-0403-2P		25		
MEH-0405-2P		30		
MEH-0407-2P		35		
MEH-0407-4P	60	7	1.8	0.4~0.75

Note: ① Motor output of 0.4 kW (4-pole) is only applicable when a TEXEL flanged induction motor is used.  
 ② Motor output of 3.7 kW is only applicable when an IEC flanged induction motor is used.  
 ③ NPSH Re values shown in the table are those obtained from the maximum suction pipe diameter.

### 60Hz Performance Curve & Technical Data

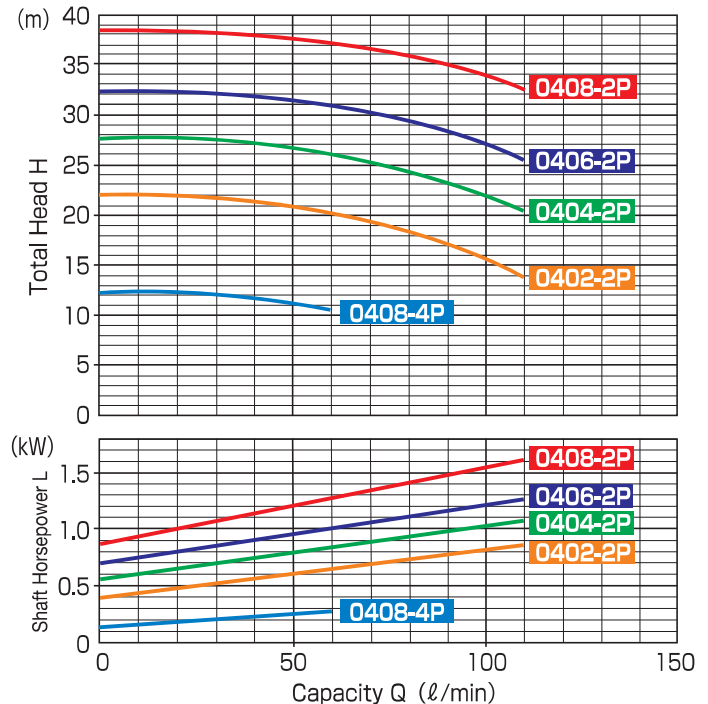

Model	Capacity (ℓ/min)	Total Head (m)	NPSH Re (m)	Motor Output (kW)
MEH-0402-2P	50	20	2.6	0.75~3.7
MEH-0404-2P		25		
MEH-0406-2P		30		
MEH-0408-2P		35		
MEH-0408-4P	60	10	2.0	0.4~0.75

Note: ① Motor output of 0.4 kW (4-pole) is only applicable when a TEXEL flanged induction motor is used.  
 ② Motor output of 3.7 kW is only applicable when an IEC flanged induction motor is used.  
 ③ NPSH Re values shown in the table are those obtained from the maximum suction pipe diameter.

## Pump Identification

**MEH-040 1 F 01 P S A 4**  
 ① ② ③ ④ ⑤ ⑥ ⑦ ⑧ ⑨

- ① Model
- ② Suction Pipe Size
- ③ Model Number Please refer to Performance Curve
- ④ O-ring Material F : FPM E : EPDM Z : Other
- ⑤ Motor Output 00 : 0.4kW 01 : 0.75kW  
02 : 1.5kW 03 : 2.2kW 05 : 3.7kW

### ⑥ Pump Body Material

Type	Casing	Impeller+Inner Magnet	Drain	Rear Casing
P		PVDF		C-PVDF
H	PVDF	ETFE	PVDF	C-PVDF
Z	Other Combinations or Special Option			

### ⑦ Motor Type

- S : TEFC/outdoor TEXEL motor A: Explosion-proof increased safety (eG3) TEXEL motor
- T : IEC standard explosion-proof (d2G4) motor C : Other

### ⑧ Parts Material Combination

Type	Shaft	Front Thrust Ring	Rear Thrust Ring	Mouth Ring	Bearing
A(Standard)	Alumina-ceramic				C-PTFE
B	SiC				
E	SiC				C-PTFE
F	Alumina-ceramic				Carbon
G	Alumina-ceramic				G-PTFE
Z	Other Combinations or Special Option				

### ⑨ Number of Poles

"4" is shown only when a 4-pole motor is installed.

Dimensions

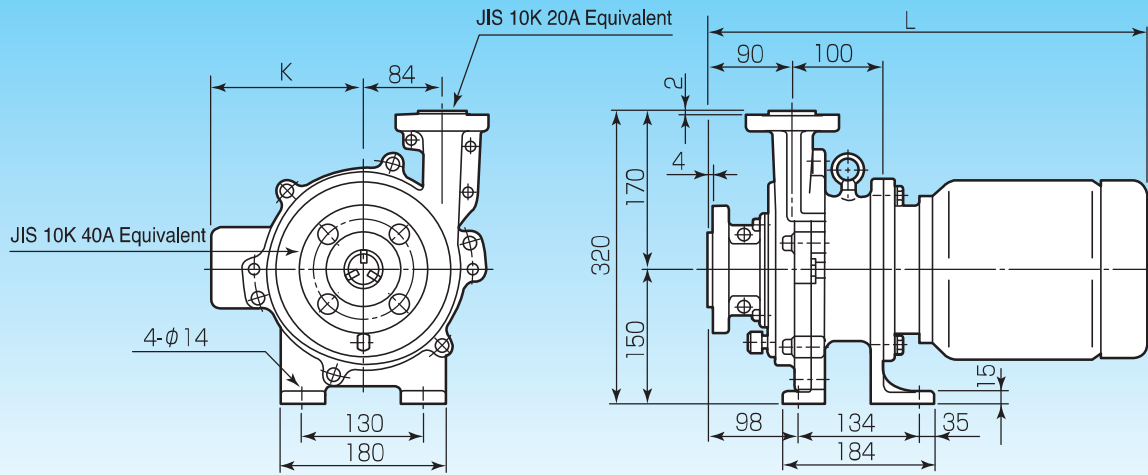

Motor Output (kW)	TEFC		eG3		Weight (kg)
	K	L	K	L	
0.4	147	415	150	424	(25)
0.75	157	447	159	460	
1.5	153	475	168	473	
2.2			176	541	

Note:

- ① The weight of pump does not include the motor weight.
- ② The dimensions shown above are applicable when a TEXEL flanged induction motor is used.
- ③ The figures in parentheses are reference values.
- ④ Please consult us when you use 3.7kW IEC flanged motor.

Construction Diagram

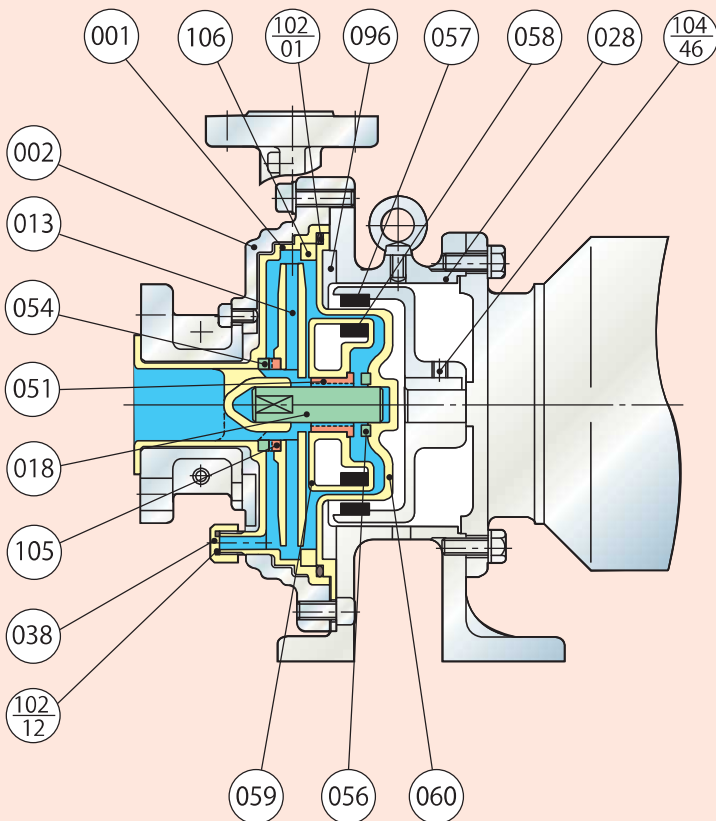

No.	Part Name	Materials
001	Casing	PVDF
002	Casing Cover	FC200
013	Impeller	PVDF/ETFE
018	Shaft	Alumina-ceramic / SiC
028	Bracket	FC200
038	Drain Plug	PVDF
051	Bearing	C-PTFE / SiC / Carbon / G-PTFE
054	Front Thrust Ring	Alumina-ceramic / SiC
056	Rear Thrust Ring	Alumina-ceramic / SiC
057	Outer Magnet	Rare Earth
058	Inner Magnet	Rare Earth
059	Magnet Lining	PVDF/ETFE
060	Rear Casing	C-PVDF
096	Bracket Ring	SS400
102-01	O-ring(Casing)	FPM/EPDM
102-12	O-ring(Drain Plug)	FPM/EPDM
104-46	Outer Magnet Set Screw	SNCM
105	Mouth Ring	C-PTFE / SiC / Carbon / G-PTFE
106	Casing Ring	PVDF

Note: Impeller has a linear channel form.  
Inner Magnet (058), Magnet Lining (059), and Impeller (013) are integrated.