

FTW FEATURES

FRP DOUBLE-IMPELLER BLOWER

MODEL FTW



Units compatible with one impeller can now house two impellers. The high-pressure blower can withstand static pressures exceeding 10 kPa. This high-pressure blower is made of highly corrosion-resistant FRP. The two-stage blower accommodates high static pressures that conventional blowers can match only when two units are connected in series. Three models are available to cover the high-static-pressure range in which blowers are frequently used.

• Reduced space requirements

This model requires less installation space than is typically required by two blowers connected in series. This results in simple, streamlined piping layouts.

• Reduced installation costs

The cantilevered structure allows for installation identical to that of a conventional blower. In addition, it requires only the same noise reduction measures required for a single unit, thus reducing the installation cost below that required for two units connected in series.

• Ease of maintenance

Because this direct-drive unit requires no V-belt link to the motor, it eliminates tension adjustment and belt checking and replacement. The work required for operation and maintenance is similar to that required by a single unit; thus, time and cost are reduced.

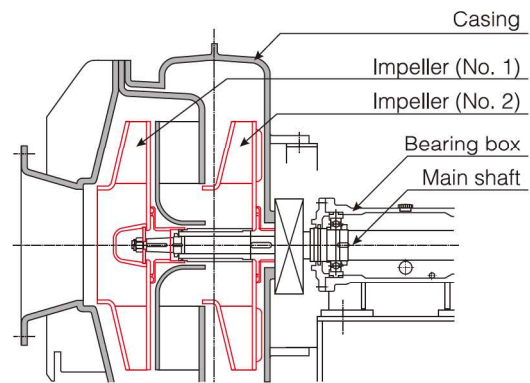

The general process of chlorine refining

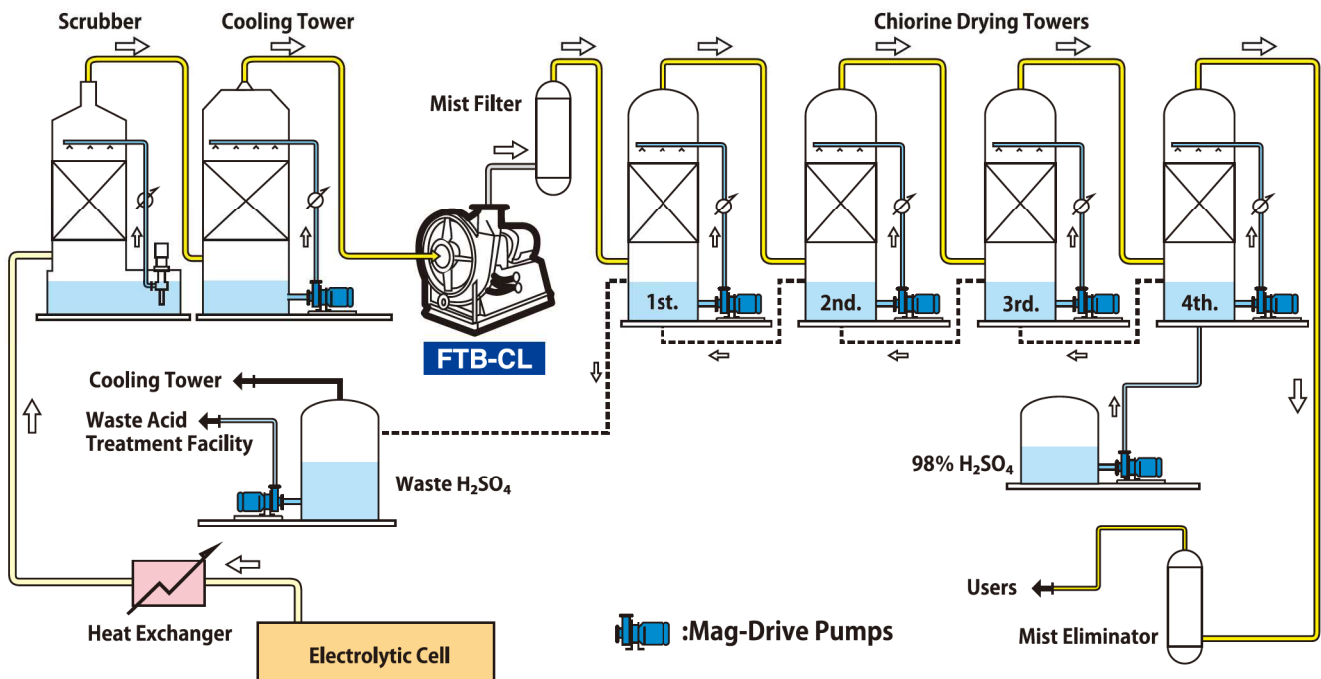

FTW 50Hz CAPACITY RANGE CHART

FTW352

CAPACITY RANGE CHART

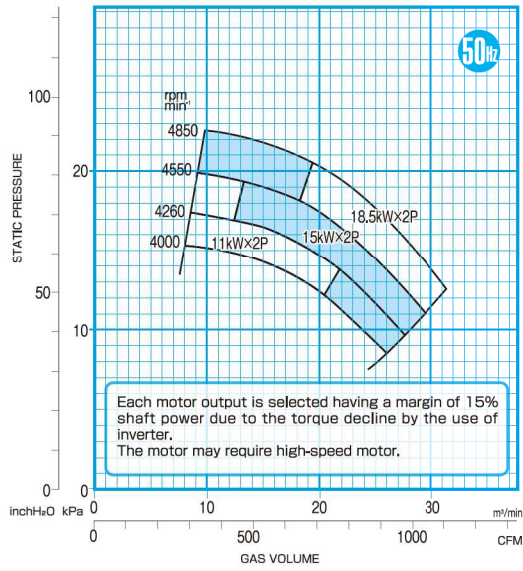

SOUND LEVEL

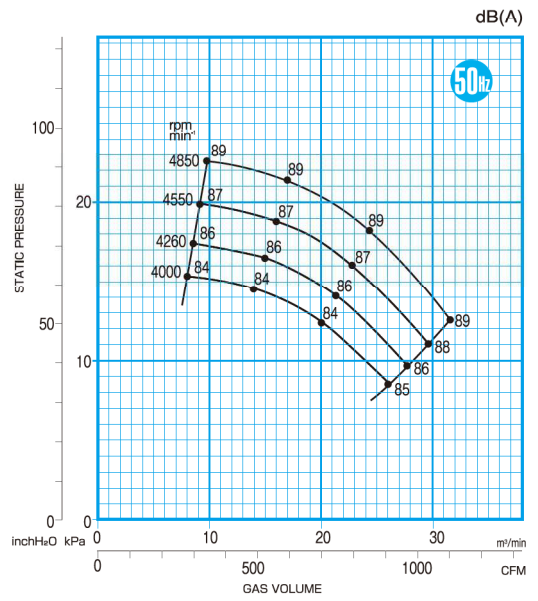

CAPACITY RANGE CHART

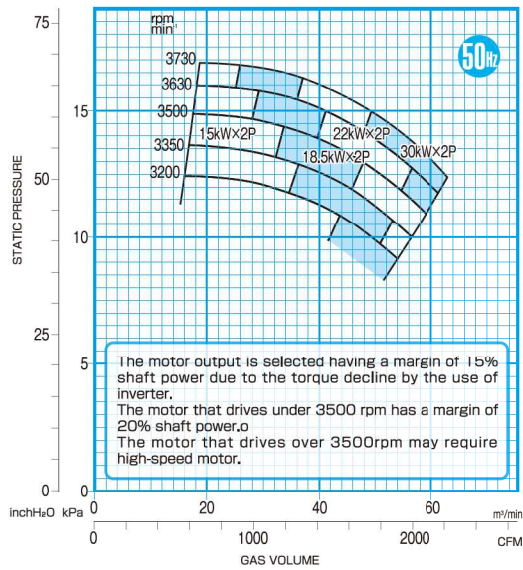

SOUND LEVEL

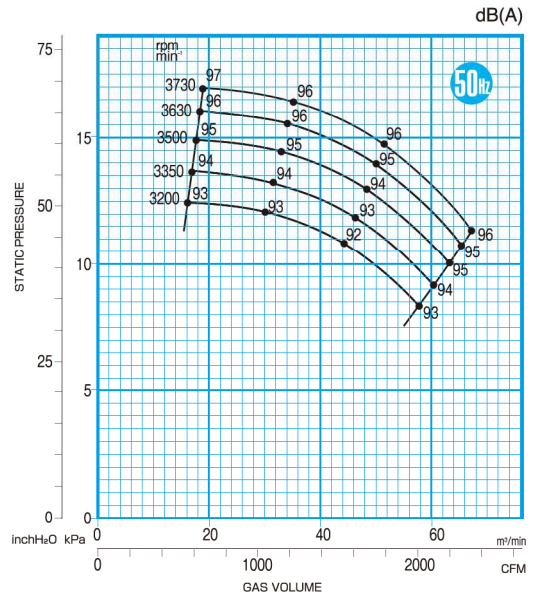

FTW401

CAPACITY RANGE CHART

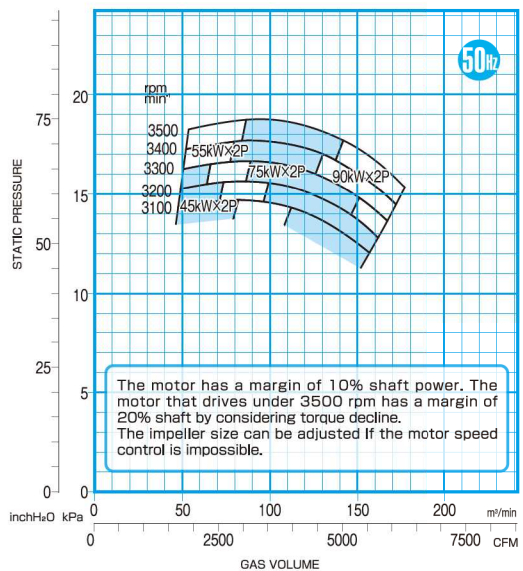

SOUND LEVEL

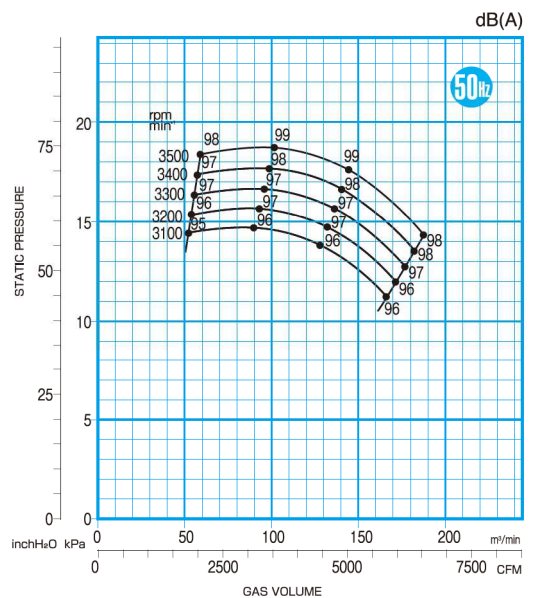

FTW403

DIMENSIONS

FTW

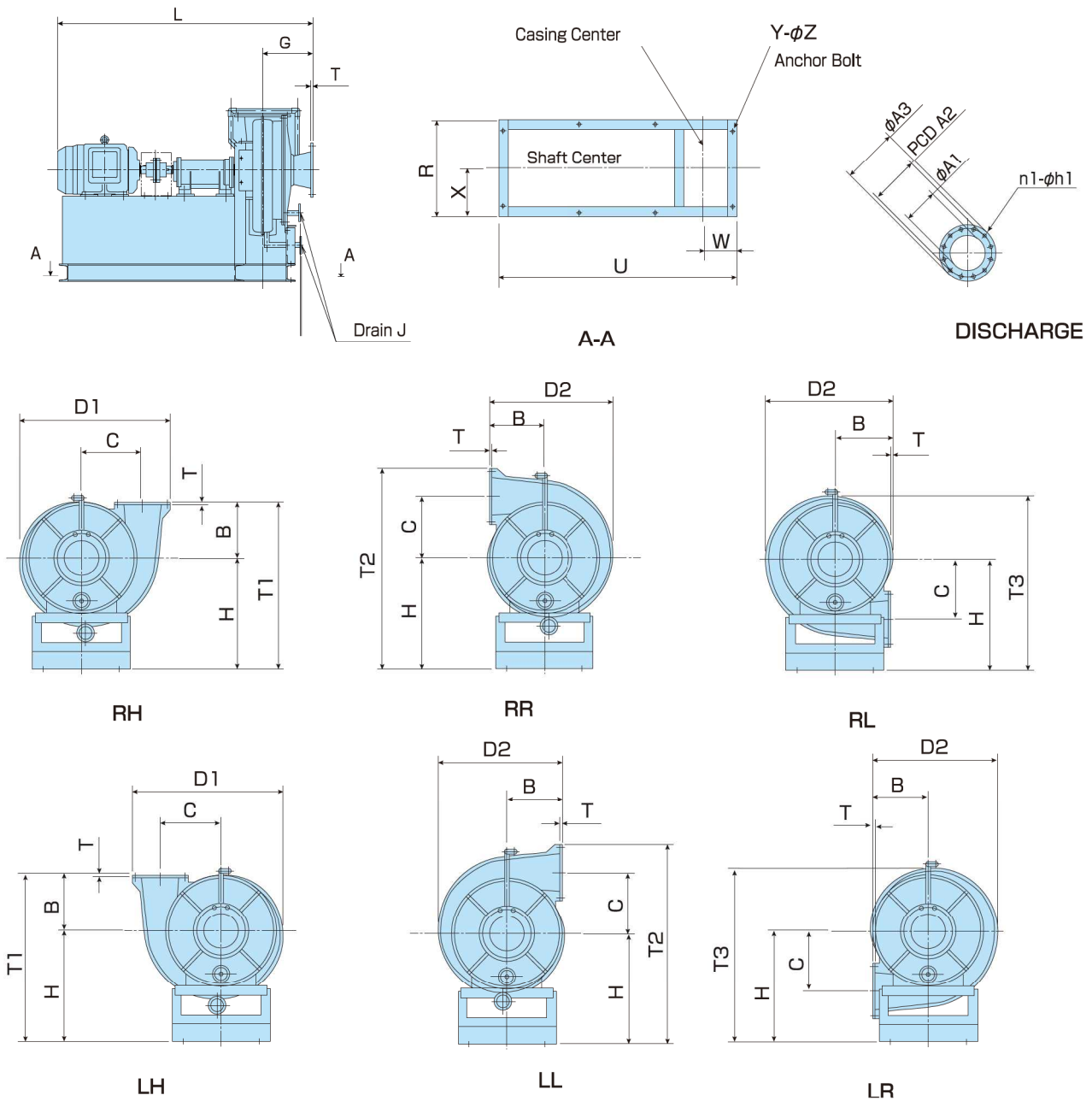

| MODEL | CASING BODY | | | | | | | | | | DRAIN | BEARING | |
|--------|-------------|-----|-----|-----|------|------|------|------|------|-----|-------|----------|-------|
| | L | H | B | C | D1 | D2 | T1 | T2 | T3 | G | J | IMPELLER | MOTOR |
| FTW352 | 1422 | 725 | 350 | 370 | 891 | 788 | 1075 | 1220 | 1121 | 280 | 25A | 6210 | 6207 |
| FTW401 | 1838 | 800 | 400 | 430 | 1076 | 898 | 1200 | 1430 | 1246 | 360 | 25A | 6215 | 6213 |
| FTW403 | 2196 | 950 | 500 | 545 | 1375 | 1175 | 1450 | 1740 | 1535 | 470 | 50A | 6215 | 6213 |

| MODEL | FLANGES | | | | | | BASE | | | | | | BODY WEIGHT |
|--------|---------|--------|-----|----|----|----|------|------|-----|-----|---|----|-------------|
| | φA1 | PDC A2 | φA3 | n1 | h2 | T | R | U | W | X | Y | Z | kg |
| FTW352 | 125 | 210 | 250 | 8 | 23 | 15 | 600 | 1300 | 164 | 300 | 8 | 1 | 420 |
| FTW401 | 250 | 355 | 400 | 12 | 25 | 15 | 700 | 1700 | 233 | 350 | 8 | 18 | 680 |
| FTW403 | 350 | 445 | 490 | 16 | 25 | 15 | 800 | 2000 | 307 | 400 | 8 | 22 | 900 |

*BODY WEIGHT : Not Including Motor Weight.

FTB403E·501B·601B·701B

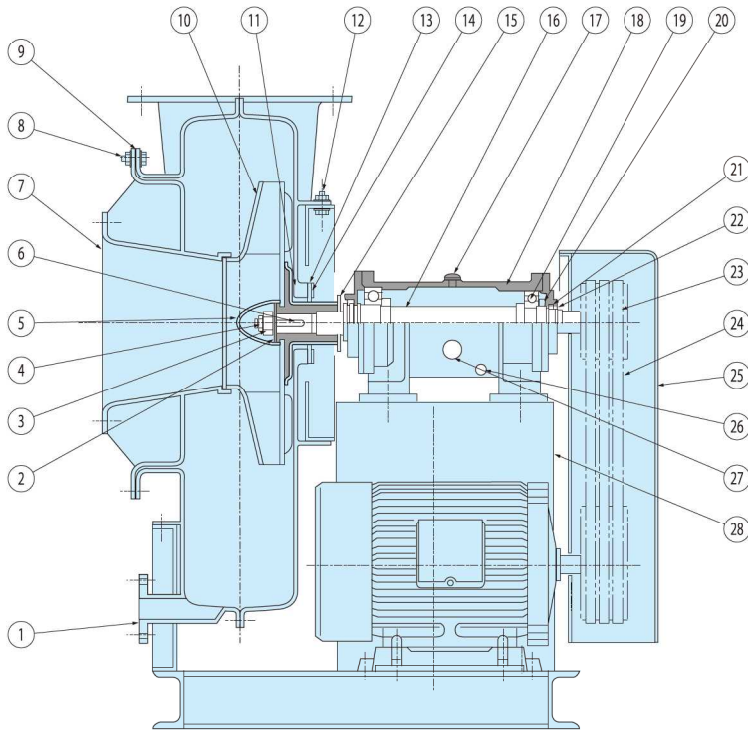

| No. | NAME OF PART | MATERIALS | QTY |
|-----|----------------------|-------------|------|
| 1 | Drain Flange | FRP | 1 |
| 2 | Washer | SS400 | 1 |
| 3 | Nut With Groove | S25C | 1 |
| 4 | Split Pin | SWRM6 | 1 |
| 5 | Nut Cover | FRP | 1 |
| 6 | Impeller Key | S45C | 1 |
| 7 | Suction Cone | FRP | 1 |
| 8 | Suction Cone Bolt | SUS304 | 1set |
| 9 | Casing Gasket | Chloroprene | 1 |
| 10 | Impeller | FRP | 1 |
| 11 | Casing | FRP | 1 |
| 12 | Casing Set Bolt | SUS304 | 1set |
| 13 | Seal Plate | PE | 1 |
| 14 | Seal Plate Support | FRP | 1 |
| 15 | Gas Separator | HTPVC | 1 |
| 16 | Shaft | S45C | 1 |
| 17 | Oil Supply Plug | PP | 1 |
| 18 | Bearing Housing | FCD450 | 1 |
| 19 | Bearing | SUJ2 | 2 |
| 20 | Bearing Nut & Washer | SS400 | 2 |
| 21 | Bearing Cover | FC200 | 2 |
| 22 | V-Ring | NBR | 2 |
| 23 | V-Pulley | FC200 | 1set |
| 24 | V-Belt | Rubber | 1set |
| 25 | V-Belt Guard | FRP | 1 |
| 26 | Oil Plug | SS400 | 1 |
| 27 | Oil Gauge | PC | 2 |
| 28 | Base | SS400 | 1 |

※No drain Flange is attached in case of RL and LR.
Number of belt may vary from that shown in this drawing.

FTW

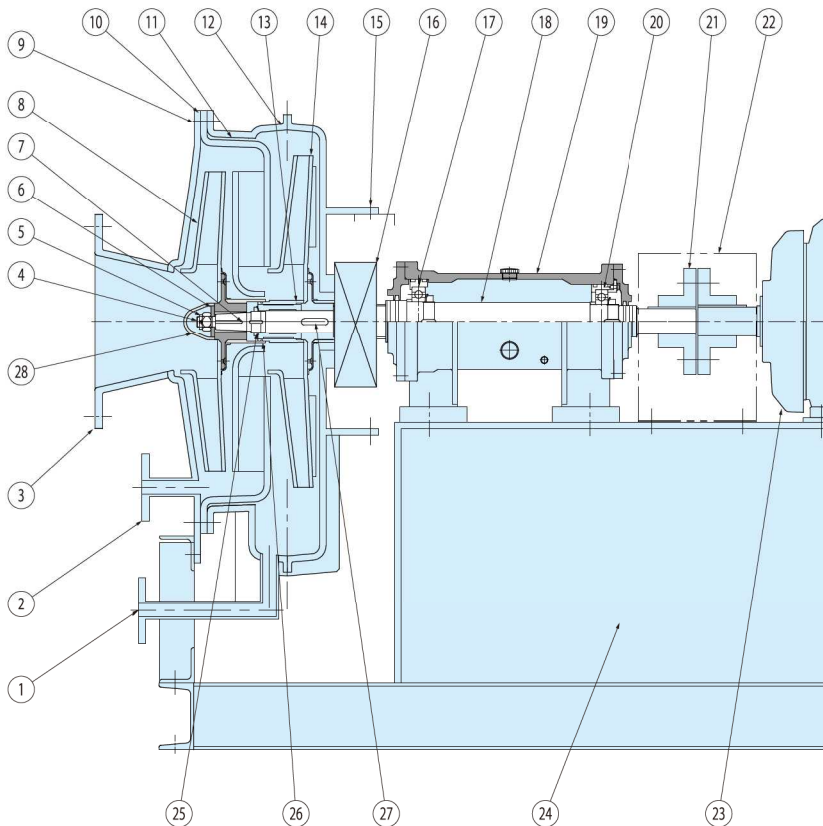

| No. | NAME OF PART | MATERIALS | QTY |
|-----|---------------------------|-----------|------|
| 1 | Drain Flange (rear) | FRP | 1 |
| 2 | Drain Flange (front) | FRP | 1 |
| 3 | Suction Cone | FRP | 1 |
| 4 | Split Pin | SWRM6 | 1 |
| 5 | Impeller Nut | S25C | 1 |
| 6 | Washer | SS400 | 1 |
| 7 | Impeller Key (front) | S45C | 1 |
| 8 | Impeller (front) | FRP | 1 |
| 9 | Casing Bolt | SUS304 | 1set |
| 10 | Gasket | EPT | 1set |
| 11 | Median Plane | FRP | 1 |
| 12 | Casing | FRP | 1 |
| 13 | Distance Piece | FRP/S25C | 1 |
| 14 | Impeller (rear) | FRP | 1 |
| 15 | Casing Set Bolt | SUS304 | 1set |
| 16 | Gland | ----- | 1set |
| 17 | Bearing | SUJ2 | 1 |
| 18 | Shaft | S45C | 1 |
| 19 | Bearing Housing | FCD450 | 1 |
| 20 | Bearing | SUJ2 | 1 |
| 21 | Coupling | SF440A | 1 |
| 22 | Coupling Cover | SS400 | 1 |
| 23 | Motor | ----- | 1 |
| 24 | Base | SS400 | 1 |
| 25 | Impeller Nut & Washer (R) | SS400 | 1 |
| 26 | O-Ring | FPM | 1 |
| 27 | Impeller Key | S45C | 1 |
| 28 | Nut Cover | FRP | 1 |

※No drain Flange is attached in case of RL and LR.